

DATASHEET

PART NUMBER

WES1760

Wescon 1760 Quick Change Chuck

Short quick change chuck with 1/4"-28 thread and 120° seat angle. Fits most right-angle drill motors for fast bit changes.

WEBSITE

<https://www.wesconusa.com/products/WES1760>



SPECIFICATIONS

Mount Type	Male Thread
Chuck Type	Quick Change
Thread Size	1/4-28
Cap Type	Ridged Cap
Seat Angle	120 Degrees
Country of Origin	USA

ADDITIONAL IMAGES AND DRAWINGS

WES1760 Quick Change Chuck

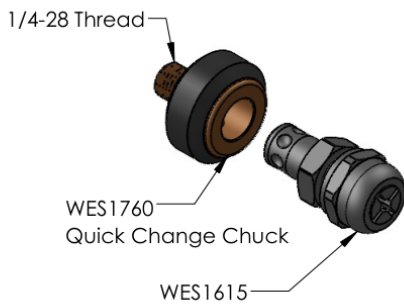
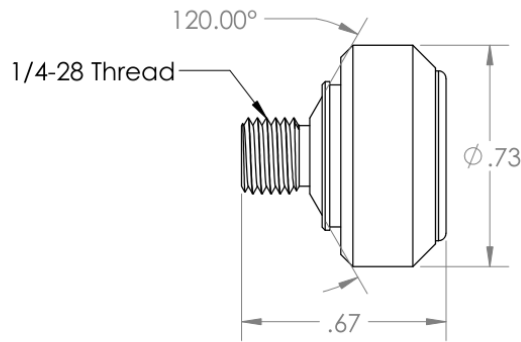
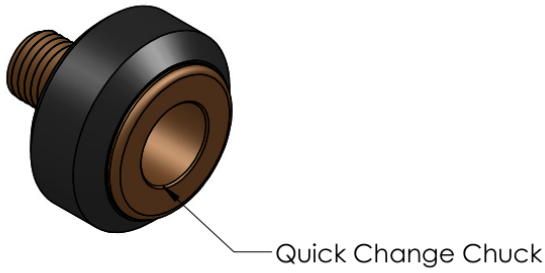

Notes from our Engineering Team

- Mounts directly to 1/4-28 threaded drill motors to provide an instant quick-change connection.
- Compatible with quick-change shank tools, WES296-S-QC Microstop and WES1615 collet for straight shank tools.



Part Number

WES1760

Do not modify, copy, distribute, or reproduce this drawing without prior written authorization.

© 2025 Wescon Industries Inc.
601 Century Plaza Dr. Houston, TX 77073, US
www.wesconusa.com

Quick Change Chuck

Revision 01

All dimensions are in Inches

Information in this drawing is provided for reference only

Image 1