

DATASHEET

PART NUMBER

WES296-6-IN-TS

**Wescon 296 Microstop - M6x1 - 12 mm Cutter
Capacity - Internal Nylon Foot**

CLOSE QUARTERS USE

WEBSITE

<https://www.wesconusa.com/products/WES296-6-IN-TS>

* The image represents the general look of the series. Actual product may vary based on options selected.

SPECIFICATIONS

| | |
|----------------------------------|-----------------------|
| Measurement Type | Metric |
| Bearing Rating | 10,000 rpm |
| Bearing Type | Dual Ball Bearings |
| Heavy Duty Thrust Bearing | No |
| Incremental Adjustment | 0.025 mm |
| Shaft Travel | 3.175 mm |
| Cutter Thread | M6x1 |
| Shaft | Threaded |
| Shaft Diameter | 6.35 mm |
| Cutter Capacity | 12 mm |
| Skirt | Internal Thread |
| Skirt Description | 12 mm Cutter Capacity |
| Foot | Nylon |
| Solid Stop | Yes |
| Material | Steel |
| Country of Origin | USA |

ADDITIONAL IMAGES AND DRAWINGS

WES296 Series Microstop



Part Number
WES296-X-XX-XX-AR



Incremental Adjustment: 0.001 in
Shaft Travel: 1/8 in
Material: Carbon Steel Body With
Hardened Tool Steel Shaft

Bearing Rating: 10,000 rpm
Bearing Type: Dual Ball-Bearings
Dust Seal: Integrated Dust Seal
Heavy Duty Thrust Bearing: No
Solid Stop: Yes

| Code | Cutter Thread |
|---------|---------------|
| (Blank) | 1/4-28 |
| 6 | M6x1 |

| Code | Foot Style |
|------|------------|
| N | Nylon |

| Code | Shaft Option |
|------|----------------------------|
| S | Round |
| QC | Quick Change |
| TS | 1/4-28in Threaded Shank |

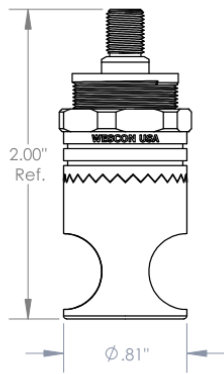

WES296-S-TS
Microstop with
1/4-28 Threaded Shank Shaft



WES296-SL-S
Microstop with
Ø 1/4" Standard Shaft



WES296-SCA-QC
Microstop with
Quick Change Shaft

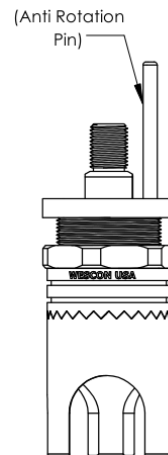

WES296-S3L-TS-AR
Microstop with
1/4-28 Threaded Shank Shaft and
Anti Rotation Pin

*For Skirt options see next page and website.



Part Number

WES296

Do not modify, copy, distribute, or reproduce this drawing without prior written authorization.

© 2025 Wescon Industries Inc.
601 Century Plaza Dr. Houston, TX 77073, US
www.wesconusa.com

Wescon 296 Microstop

Revision 04

All dimensions are in Inches

Information in this drawing is provided for reference only

Image 1

Skirt Option

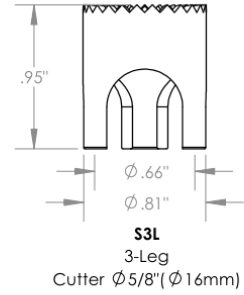
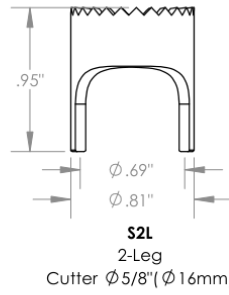
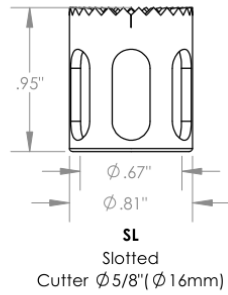
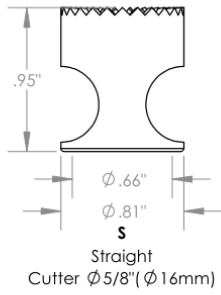

| Part Number | Material |
|-------------|----------|
| 29620-N | Nylon |
| 29620-S | Steel |
| 29620-P | Phenolic |

Foot Style For Internal Thread



Part Number

WES296

Do not modify, copy, distribute, or reproduce this drawing without prior written authorization.

© 2025 Wescon Industries Inc.
601 Century Plaza Dr. Houston, TX 77073, US
www.wesconusa.com

Wescon 296 Microstop

Revision 04

All dimensions are in Inches

Information in this drawing is provided for reference only

Image 2