

DATASHEET

PART NUMBER

WES296-6-SL-TS

Wescon 296 Microstop - M6x1 - 15 mm Cutter Capacity - Slotted

CLOSE QUARTERS USE

WEBSITE

<https://www.wesconusa.com/products/WES296-6-SL-TS>



* The image represents the general look of the series. Actual product may vary based on options selected.

SPECIFICATIONS

Measurement Type	Metric
Bearing Rating	10,000 rpm
Bearing Type	Dual Ball Bearings
Heavy Duty Thrust Bearing	No
Incremental Adjustment	0.025 mm
Shaft Travel	3.175 mm
Cutter Thread	M6x1
Shaft	Threaded
Shaft Diameter	6.35 mm
Cutter Capacity	15 mm
Skirt	Slotted
Skirt Description	20.57 mm OD 16.76 mm ID 15 mm Cutter Capacity
Solid Stop	Yes
Material	Steel
Country of Origin	USA

ADDITIONAL IMAGES AND DRAWINGS

WES296 Series Microstop



Part Number
WES296-X-XX-XX-AR



Incremental Adjustment: 0.001 in
Shaft Travel: 1/8 in
Material: Carbon Steel Body With
Hardened Tool Steel Shaft

Bearing Rating: 10,000 rpm
Bearing Type: Dual Ball-Bearings
Dust Seal: Integrated Dust Seal
Heavy Duty Thrust Bearing: No
Solid Stop: Yes

Code	Cutter Thread
(Blank)	1/4-28
6	M6x1

Code	Foot Style
N	Nylon

Code	Shaft Option
S	Round
QC	Quick Change
TS	1/4-28in Threaded Shank

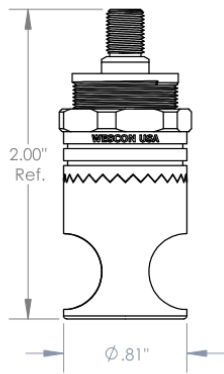

WES296-S-TS
Microstop with
1/4-28 Threaded Shank Shaft



WES296-SL-S
Microstop with
Ø 1/4" Standard Shaft



WES296-SCA-QC
Microstop with
Quick Change Shaft

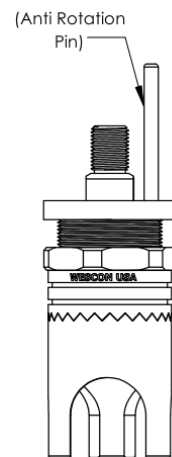

WES296-S3L-TS-AR
Microstop with
1/4-28 Threaded Shank Shaft and
Anti Rotation Pin

*For Skirt options see next page and website.



Part Number

WES296

Do not modify, copy,
distribute, or reproduce
this drawing without prior
written authorization.

© 2025 Wescon Industries Inc.
601 Century Plaza Dr. Houston, TX 77073, US
www.wesconusa.com

Wescon 296 Microstop

Revision 04

All dimensions are in Inches

Information in this drawing is provided for reference only

Image 1

Skirt Option

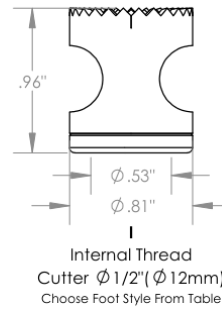
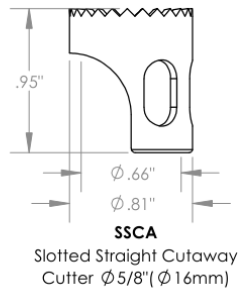
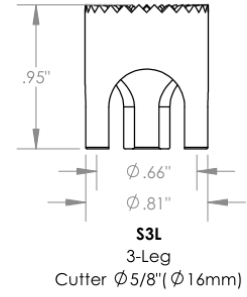
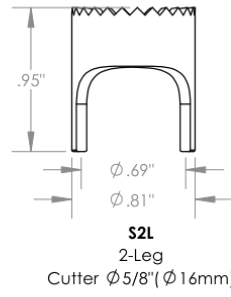

Part Number	Material
29620-N	Nylon
29620-S	Steel
29620-P	Phenolic

Foot Style For Internal Thread



Part Number **WES296**

Do not modify, copy, distribute, or reproduce this drawing without written authorization.

© 2025 Wescon Industries Inc.
601 Century Plaza Dr. Houston, TX 77073, US
www.wesconusa.com

Wescon 296 Microstop

Revision 04 All dimensions are in Inches Information in this drawing is provided for reference only

Image 2