

## DATASHEET

PART NUMBER

### WES296-6-SSCA

**Wescon 296 Microstop - M6x1 - 15 mm Cutter Capacity - Slotted Straight Cutaway**

CLOSE QUARTERS USE

WEBSITE

<https://www.wesconusa.com/products/WES296-6-SSCA>



\* The image represents the general look of the series. Actual product may vary based on options selected.

## SPECIFICATIONS

<b>Measurement Type</b>	Metric
<b>Bearing Rating</b>	10,000 rpm
<b>Bearing Type</b>	Dual Ball Bearings
<b>Heavy Duty Thrust Bearing</b>	No
<b>Incremental Adjustment</b>	0.025 mm
<b>Shaft Travel</b>	3.175 mm
<b>Cutter Thread</b>	M6x1
<b>Shaft</b>	Round
<b>Shaft Diameter</b>	6.35 mm
<b>Cutter Capacity</b>	15 mm
<b>Skirt</b>	Slotted Straight Cutaway
<b>Skirt Description</b>	20.57 mm OD 16.76 mm ID 15 mm Cutter Capacity
<b>Solid Stop</b>	Yes
<b>Material</b>	Steel
<b>Country of Origin</b>	USA

**ADDITIONAL IMAGES AND DRAWINGS**

**WES296 Series Microstop**



**Part Number**  
WES296-X-XX-XX-AR



Incremental Adjustment: 0.001 in  
Shaft Travel: 1/8 in  
Material: Carbon Steel Body With  
Hardened Tool Steel Shaft

Bearing Rating: 10,000 rpm  
Bearing Type: Dual Ball-Bearings  
Dust Seal: Integrated Dust Seal  
Heavy Duty Thrust Bearing: No  
Solid Stop: Yes

Code	Cutter Thread
(Blank)	1/4-28
6	M6x1

Code	Foot Style
N	Nylon

Code	Shaft Option
S	Round
QC	Quick Change
TS	1/4-28in Threaded Shank

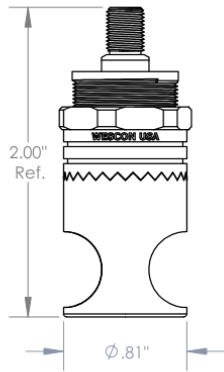

**WES296-S-TS**  
Microstop with  
1/4-28 Threaded Shank Shaft



**WES296-SL-S**  
Microstop with  
Ø 1/4" Standard Shaft



**WES296-SCA-QC**  
Microstop with  
Quick Change Shaft

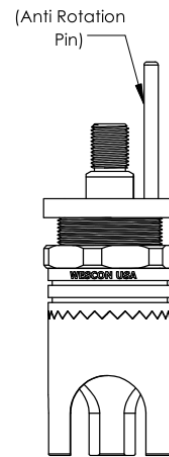

**WES296-S3L-TS-AR**  
Microstop with  
1/4-28 Threaded Shank Shaft and  
Anti Rotation Pin

\*For Skirt options see next page and website.



Part Number **WES296**

Do not modify, copy, distribute, or reproduce this drawing without prior written authorization.

© 2025 Wescon Industries Inc.  
601 Century Plaza Dr. Houston, TX 77073, US  
www.wesconusa.com

Wescon 296 Microstop

Revision 04 All dimensions are in Inches Information in this drawing is provided for reference only

Image 1

### Skirt Option

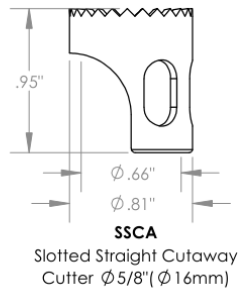
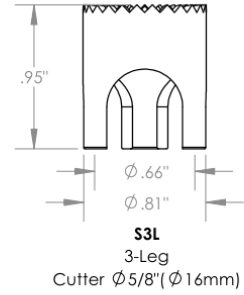
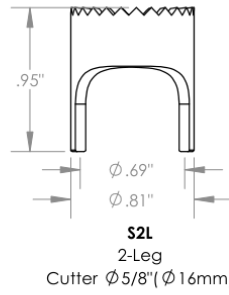
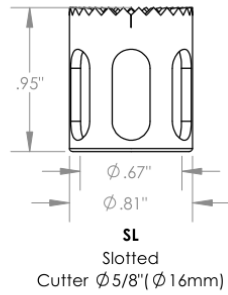
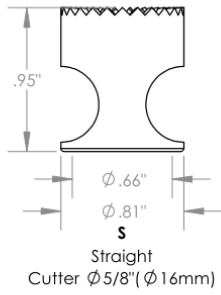

Part Number	Material
29620-N	Nylon
29620-S	Steel
29620-P	Phenolic

Foot Style For Internal Thread



Part Number **WES296**

Do not modify, copy, distribute, or reproduce this drawing without written authorization.

© 2025 Wescon Industries Inc.  
601 Century Plaza Dr. Houston, TX 77073, US  
www.wesconusa.com

Wescon 296 Microstop

Revision 04 All dimensions are in Inches Information in this drawing is provided for reference only

Image 2