

## DATASHEET

PART NUMBER

### WES597-S-TF

**Wescon 597 Stainless Steel Microstop - 1/4-28  
- 3/4" Cutter Capacity - Straight Skirt**

HIGH SPEED HEAVY DUTY STAINLESS STEEL

WEBSITE

<https://www.wesconusa.com/products/WES597-S-TF>



\* The image represents the general look of the series. Actual product may vary based on options selected.

## SPECIFICATIONS

|                                  |                                |
|----------------------------------|--------------------------------|
| <b>Measurement Type</b>          | Imperial                       |
| <b>Bearing Rating</b>            | 10,000 rpm                     |
| <b>Bearing Type</b>              | Dual Ball Bearings             |
| <b>Heavy Duty Thrust Bearing</b> | Yes                            |
| <b>Incremental Adjustment</b>    | 0.0005 in                      |
| <b>Shaft Travel</b>              | 0.300 in                       |
| <b>Dust Seal</b>                 | Integrated Dust Seal           |
| <b>Cutter Thread</b>             | 1/4-28                         |
| <b>Shaft</b>                     | Tri-Flat                       |
| <b>Shaft Diameter</b>            | 1/4 in                         |
| <b>Cutter Capacity</b>           | 3/4 in                         |
| <b>Skirt</b>                     | Straight                       |
| <b>Skirt Description</b>         | 1 in OD 3/4 in Cutter Capacity |
| <b>Solid Stop</b>                | Yes                            |
| <b>Material</b>                  | Stainless Steel                |
| <b>Country of Origin</b>         | USA                            |

**ADDITIONAL IMAGES AND DRAWINGS**

**WES597 SERIES MICROSTOP**

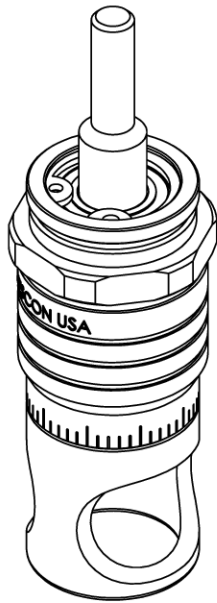

**Part Number**  
WES597-X-XX-XX

- Shaft Option
- Foot Style
- Skirt Option\*
- Cutter Thread

| Code    | Cutter Thread |
|---------|---------------|
| (Blank) | 1/4-28        |
| 6       | M6x1          |
| 8       | M8x1          |

| Code | Foot Style |
|------|------------|
| N    | Nylon      |
| S    | Steel      |
| P    | Phenolic   |

| Code    | Shaft Option                 |
|---------|------------------------------|
| (Blank) | 1/4in Standard Round         |
| -QC     | Quick Change                 |
| -TF     | Tri Flat                     |
| -TSL    | 1/4-28in Threaded Shank Long |

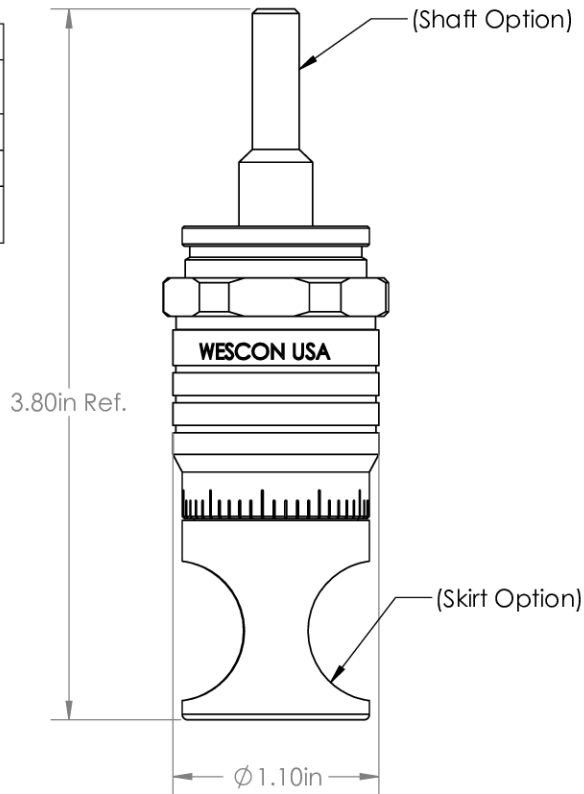

Incremental Adjustment: 0.0005 in  
Shaft Travel: 0.300 in  
Material: Stainless Steel

Bearing Rating: 10,000 rpm  
Bearing Type: Dual Ball-Bearings  
Dust Seal: Integrated Dust Seal  
Heavy Duty Thrust Bearing: Yes  
Solid Stop: Yes

\*For Skirt options see next page and website.



Part Number **WES597**

Do not modify, copy, distribute, or reproduce this drawing without prior written authorization.

© 2025 Wescon Industries Inc.  
601 Century Plaza Dr. Houston, TX 77073, US  
www.wesconusa.com

Wescon 597 Microstop

All dimensions are in inches. Information in this drawing is provided for reference only.

Image 1

**Skirt Option**

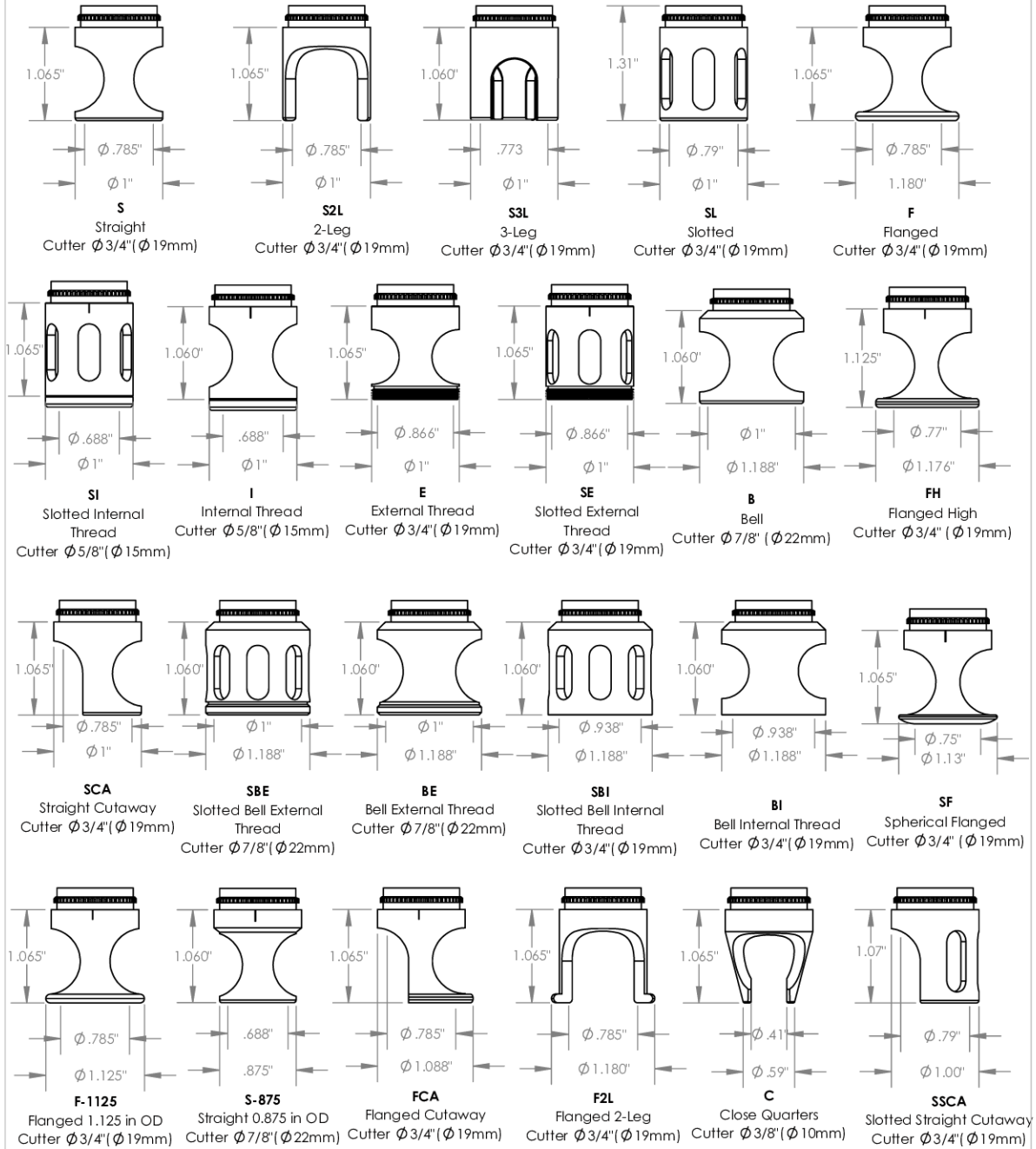

Part Number **WES597**

Do not modify, copy, distribute, or reproduce this drawing without prior written authorization.

© 2025 Wescon Industries Inc.  
601 Century Plaza Dr. Houston, TX 77073, US  
www.wesconusa.com

Wescon 597 Microstop

Continued In Next Page.

All dimensions are in Inches Information in this drawing is provided for reference only

Image 2

Skirt Option (Continuation)

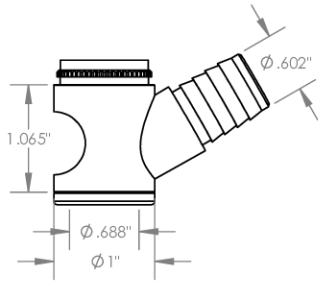

**VI**  
Vacuum Internal  
Thread  
Cutter  $\phi 5/8"$  ( $\phi 15\text{mm}$ )

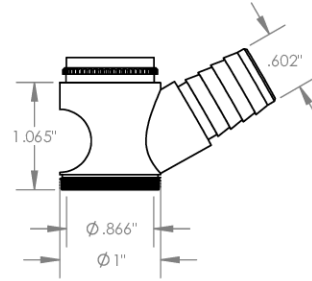

**VE**  
Vacuum External  
Thread  
Cutter  $\phi 3/4"$  ( $\phi 19\text{mm}$ )

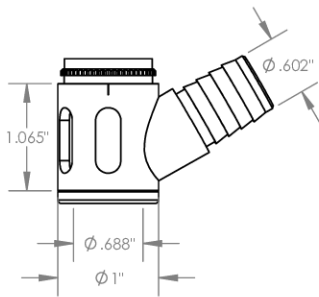

**SVI**  
Slotted Vacuum External  
Thread  
Cutter  $\phi 5/8"$  ( $\phi 15\text{mm}$ )

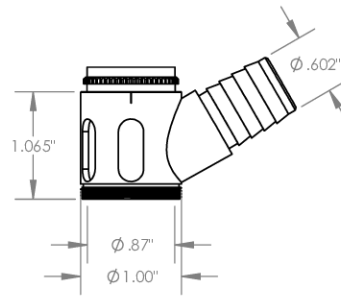

**SVE**  
Slotted Vacuum External  
Thread  
Cutter  $\phi 3/4"$  ( $\phi 19\text{mm}$ )



Part Number

**WES597**

Do not modify, copy, distribute, or reproduce this drawing without prior written authorization.

© 2025 Wescon Industries Inc.  
601 Century Plaza Dr. Houston, TX 77073, US  
www.wesconusa.com

Wescon 597 Microstop

All dimensions are in inches

Information in this drawing is provided for reference only

Image 3

**Foot Style  
For External Thread**

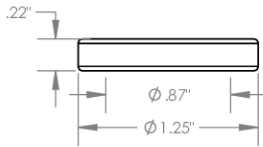

| Part Number | Material |
|-------------|----------|
| 59631-N     | Nylon    |
| 59631-S     | Steel    |
| 59361-P     | Phenolic |

**Foot Style  
For Internal Thread**

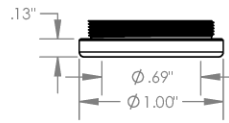

| Part Number | Material |
|-------------|----------|
| 59620-N     | Nylon    |
| 59620-S     | Steel    |
| 59620-P     | Phenolic |

**Foot Style  
For Bell External Thread**

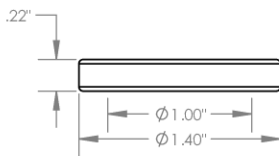

| Part Number | Material |
|-------------|----------|
| 59641-N     | Nylon    |
| 59641-S     | Steel    |
| 59641-P     | Phenolic |

**Foot Style  
For Bell Internal Thread**

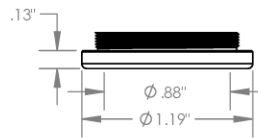

| Part Number | Material |
|-------------|----------|
| 59640-N     | Nylon    |
| 59640-S     | Steel    |
| 59640-P     | Phenolic |



Part Number  
**WES597**

Do not modify, copy, distribute, or reproduce this drawing without prior written authorization.

© 2025 Wescon Industries Inc.  
601 Century Plaza Dr. Houston, TX 77073, US  
www.wesconusa.com

Wescon 597 Microstop

All dimensions are in inches. Information in this drawing is provided for reference only.

Image 4