

DATASHEET

PART NUMBER

WES690-1500-EN-4320-TF

**Wescon 690 Microstop - 7/16-20 - 1-1/2" Cutter
Capacity - External Nylon Foot**

LARGE CAPACITY UNITS

WEBSITE

<https://www.wesconusa.com/products/WES690-1500-EN-4320-TF>



* The image represents the general look of the series. Actual product may vary based on options selected.

SPECIFICATIONS

| | |
|---------------------------|-----------------|
| Measurement Type | Imperial |
| Bearing Rating | 3,000 rpm |
| Bearing Type | Bronze Bearing |
| Heavy Duty Thrust Bearing | Yes |
| Incremental Adjustment | 0.0005 in |
| Shaft Travel | 1/2 in |
| Dust Seal | No |
| Cutter Thread | 7/16-20 |
| Shaft | Tri-Flat |
| Shaft Diameter | 3/8 in |
| Cutter Capacity | 1-1/2 in |
| Skirt | External Thread |
| Foot | Nylon |
| Solid Stop | No |
| Material | Steel |
| Country of Origin | USA |

ADDITIONAL IMAGES AND DRAWINGS

WES690 Series Microstop



Part Number

WES690-XX-XX-XX-XX

- Shaft Option
- Foot Style
- Skirt Option*
- Cutter Capacity
- Shaft Thread

| Code | Shaft Thread |
|---------|--------------|
| (Blank) | 3/8-24 |
| 4320 | 7/16-20 |
| 8 | M8x1 |
| 10 | M10x1 |

| Code | Cutter Capacity |
|------|-----------------|
| 875 | 7/8"(22mm) |
| 1000 | 1"(25mm) |
| 1250 | 1-1/4"(32mm) |
| 1375 | 1-3/8"(35mm) |
| 1500 | 1-1/2"(38mm) |
| 2000 | 2"(50.8mm) |

| Code | Foot Style |
|------|------------|
| N | Nylon |
| S | Steel |

| Code | Shaft Option |
|------|--------------|
| TF | Tri Flat |



Incremental Adjustment: 0.0005 in
 Shaft Travel: 0.500 in
 Material: Carbon Steel Body with
 Hardened Tool Steel Shaft

Bearing Rating: 3,000 rpm
 Bearing Type: Bronze Bearing
 Heavy Duty Thrust Bearing: Yes
 Solid Stop: Yes

*For skirt options see next page and website.



Part Number

WES690

Do not modify, copy, distribute, or reproduce this drawing without prior written authorization.

© 2025 Wescon Industries Inc.
 601 Century Plaza Dr. Houston, TX 77073. US
 www.wesconusa.com

Wescon 690 Microstop

Revision 03 All dimensions are in Inches Information in this drawing is provided for reference only

Image 1

Skirt Option



Foot Style For External Thread



E
External Thread
Choose Foot Style From Table

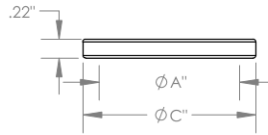

| Part Number | Material |
|-------------|----------|
| 59631-N | Nylon |
| 59631-S | Steel |
| 59631-P | Phenolic |

| Code | Cutter Capacity | ϕA | OD for S,SCA,S2L & S3L | | OD for E & SE |
|------|-----------------|----------------|------------------------|-----------------|---------------|
| | | | ϕB | ϕC | |
| 875 | 7/8"(22 mm) | 7/8" (22 mm) | 1-3/16" (30 mm) | 1.317 (33 mm) | |
| 1000 | 1"(25 mm) | 1-5/8" (42 mm) | 1-7/8" (48 mm) | 1.945 (49 mm) | |
| 1250 | 1-1/4"(32 mm) | 1-1/2" (38 mm) | 1-5/8" (42 mm) | 1.755 (45 mm) | |
| 1375 | 1-3/8"(35 mm) | 1-5/8" (42 mm) | 1-7/8" (48 mm) | 2.005 (50.8 mm) | |
| 1500 | 1-1/2"(38 mm) | 1-1/2" (38 mm) | 2" (50.8 mm) | 2.130 (54 mm) | |
| 2000 | 2"(50.8 mm) | 2-1/4" (58 mm) | 2-1/2" (64 mm) | 2.630 (67 mm) | |



Part Number

WES690

Do not modify, copy, distribute, or reproduce this drawing without prior written authorization.

© 2025 Wescon Industries Inc.
601 Century Plaza Dr. Houston, TX 77073, US
www.wesconusa.com

Wescon 690 Microstop

Revision 03

All dimensions are in inches

Information in this drawing is provided for reference only

Image 2